



PET Vocal Booth

Portable Vocal and Singing Booth

Thomann GmbH
Hans-Thomann-Straße 1
96138 Burgebrach
Germany
Telephone: +49 (0) 9546 9223-0
Internet: www.thomann.de

30.04.2024, ID: 586828 (V2)

Table of contents

1 General information..... 4

1.1 Symbols and signal words..... 4

2 Safety instructions..... 5

3 Features..... 6

4 Scope of delivery..... 7

5 Installation..... 8

6 Disassembling..... 13

7 Technical specifications..... 14

8 Protecting the environment..... 15

1 General information

This document contains important instructions for the safe operation of the product. Read and follow the safety instructions and all other instructions. Keep the document for future reference. Make sure that it is available to all those using the product. If you sell the product to another user, be sure that they also receive this document.

Our products and documentation are subject to a process of continuous development. They are therefore subject to change. Please refer to the latest version of the documentation, which is ready for download under www.thomann.de.

1.1 Symbols and signal words

In this section you will find an overview of the meaning of symbols and signal words that are used in this document.

Signal word	Meaning
DANGER!	This combination of symbol and signal word indicates an immediate dangerous situation that will result in death or serious injury if it is not avoided.
CAUTION!	This combination of symbol and signal word indicates a possible dangerous situation that can result in minor injury if it is not avoided.
NOTICE!	This combination of symbol and signal word indicates a possible dangerous situation that can result in material and environmental damage if it is not avoided.
Warning signs	Type of danger
	Warning – danger zone.

2 Safety instructions

Intended use

This product is designed to optimise acoustics during voice and singing recordings. Use the product only as described in this user manual. Any other use or use under other operating conditions is considered to be improper and may result in personal injury or property damage. No liability will be assumed for damage resulting from improper use.

This product may be used only by persons with sufficient physical, sensory, and intellectual abilities and with the relevant knowledge and experience. Other persons may use this device only if they are supervised or instructed by a person who is responsible for their safety.

Safety

DANGER!

Risk of injury and choking hazard for children!

Children can suffocate on packaging material and small parts. Children can injure themselves when handling the product. Never allow children to play with the packaging material and the product. Always store packaging material out of the reach of babies and small children. Always dispose of packaging material properly when it is not in use. Never allow children to use the product without supervision. Keep small parts away from children and make sure that the product does not shed any small parts that children could play with.

CAUTION!

Risk of injury due to the heavy weight of the product

The product is heavy. Lifting and dropping it during transport and installation can cause injuries. Handle the product carefully during transport and assembly, and ask a second person to help if necessary.

CAUTION!

Risk of injury due to tipping in case of improper use!

If subjected to force, the assembled product can tip over and cause injuries and damage. The product cannot hold people. Do not lean on the product and do not use it as a support. Never sit on the product, and never suspend heavy loads above it.

NOTICE!

Risk of breaking shelf due to overloading!

In case of excessive and uneven loading of the shelf, the shelf can break and cause damage. Never exceed the specified maximum load for the shelf.

NOTICE!

Risk of fire due to incorrect polarity!

Incorrectly inserted batteries may cause fires and destroy the device and the batteries. Observe the markings on the batteries and on the device. Ensure that proper polarity is observed when inserting batteries.

NOTICE!

Possible damage due to leaking batteries!

Batteries can leak and cause permanent damage to the device. Take the batteries out of the device if it is not going to be used for an extended period of time.

3 Features

- Suitable for the optimised recording of vocals, singing and instruments
- Suitable for sound studios, radio stations, podcast and streaming rooms, home recording and Hi-Fi rooms
- Easy to assemble thanks to plug-in system
- Elements made from PET
- Built-in shelf
- Headphone holder
- Hole for cable feedthrough
- Two curtains with magnetic catch
- Including two battery-powered LED lamps (batteries not included)
- Ceiling element with magnetic holder for attaching the LED lamps

4 Scope of delivery



Before you assemble the portable vocal and singing booth, make sure the contents of package is complete according to the following overview.

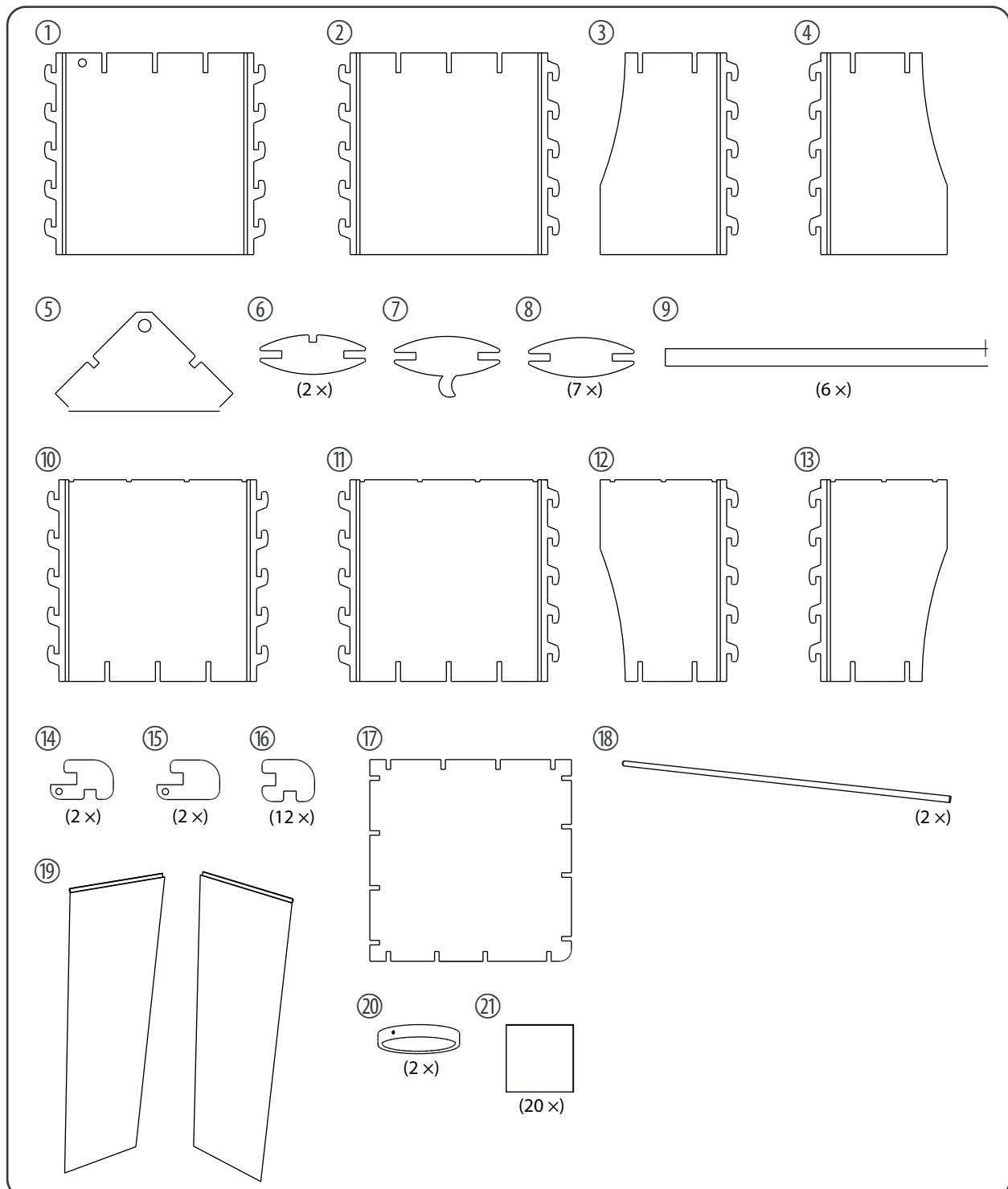

5 Installation

Mount the various elements in the specified sequence.

Step 1

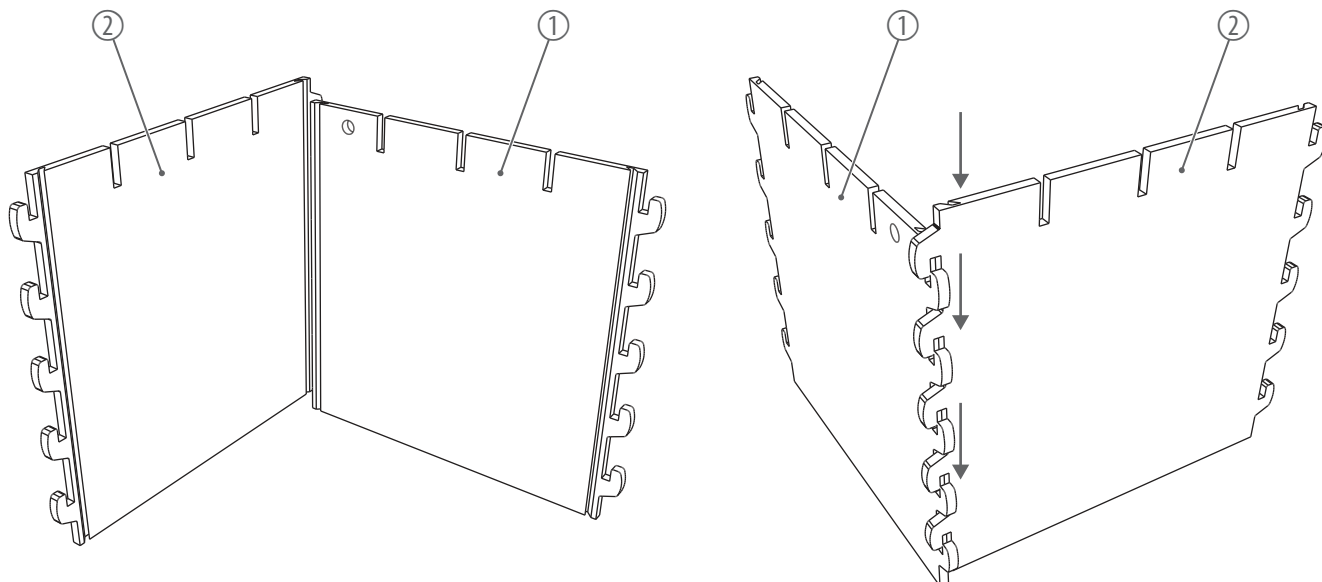

Step 2

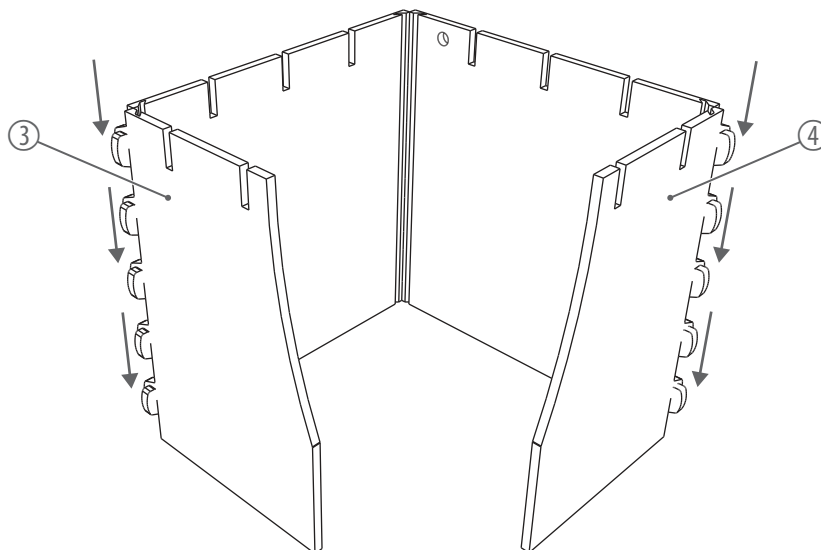

Step 3

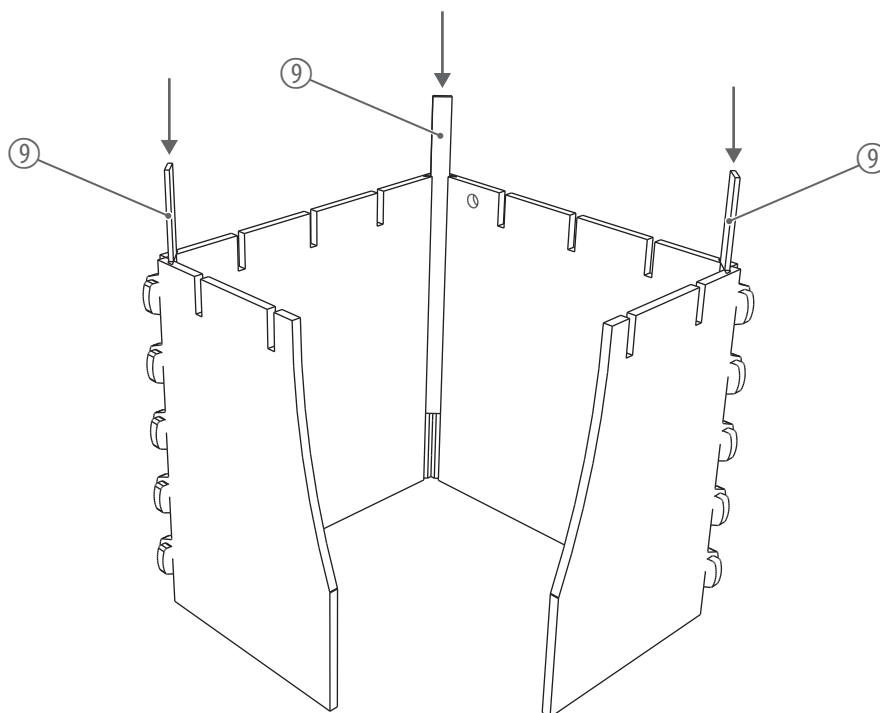

Step 4

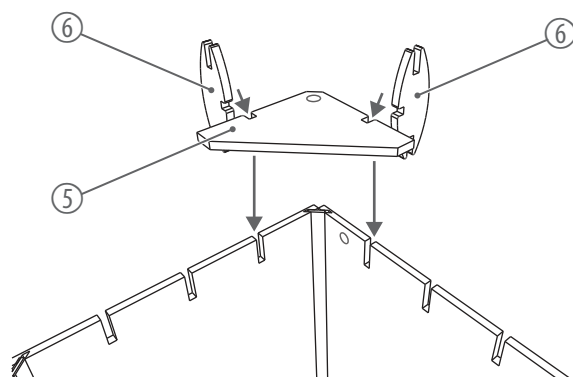

Step 5

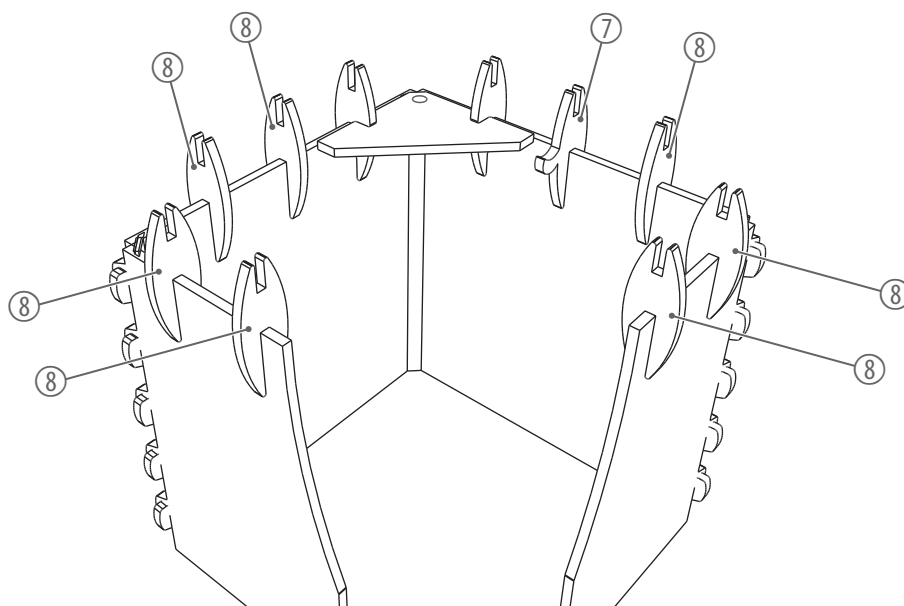

Step 6

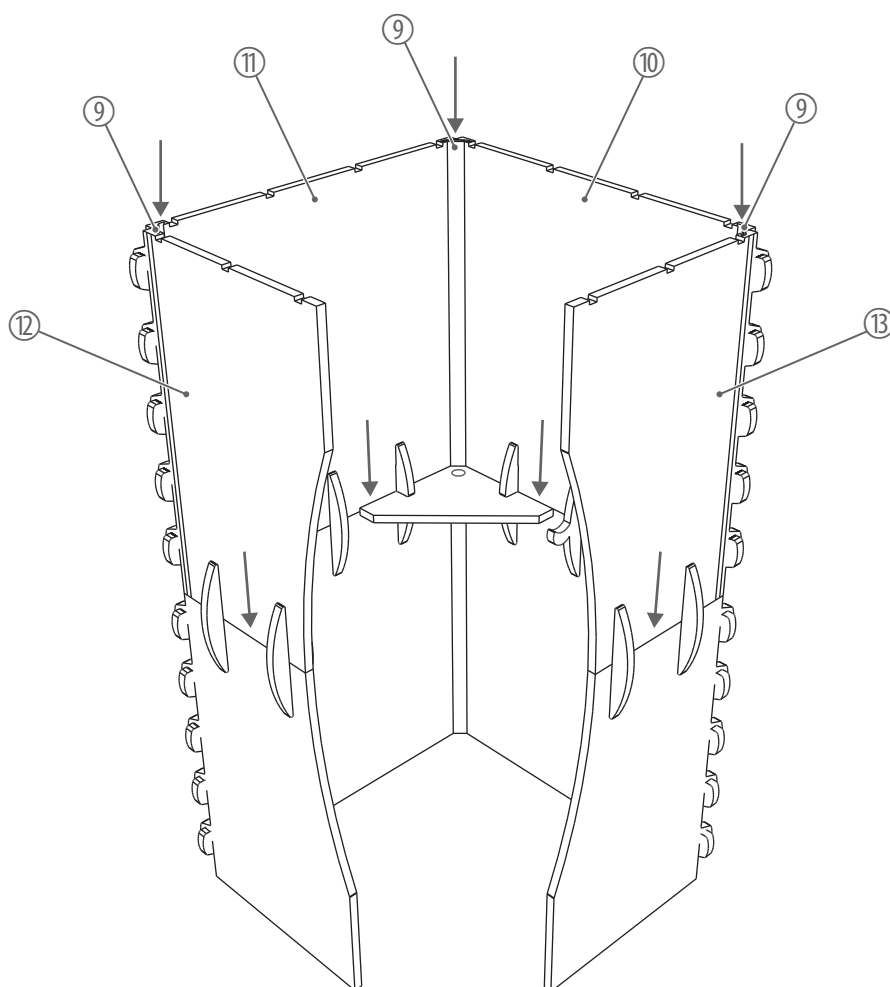

Step 7

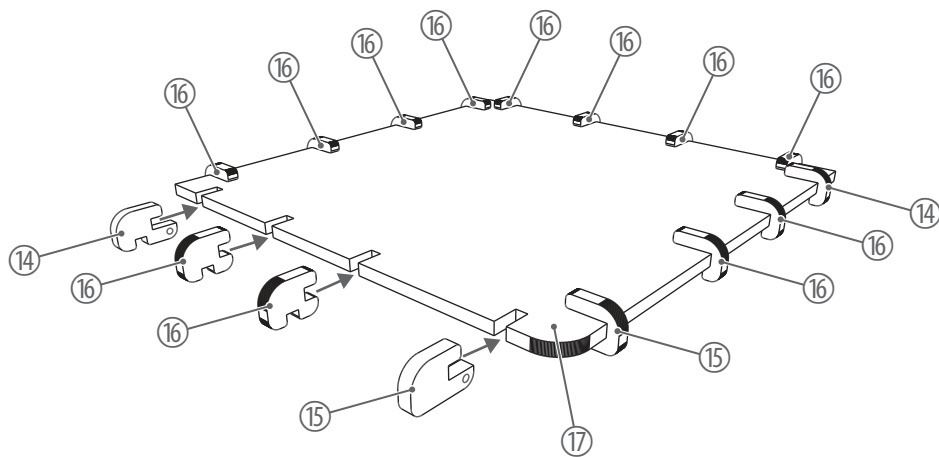

Step 8

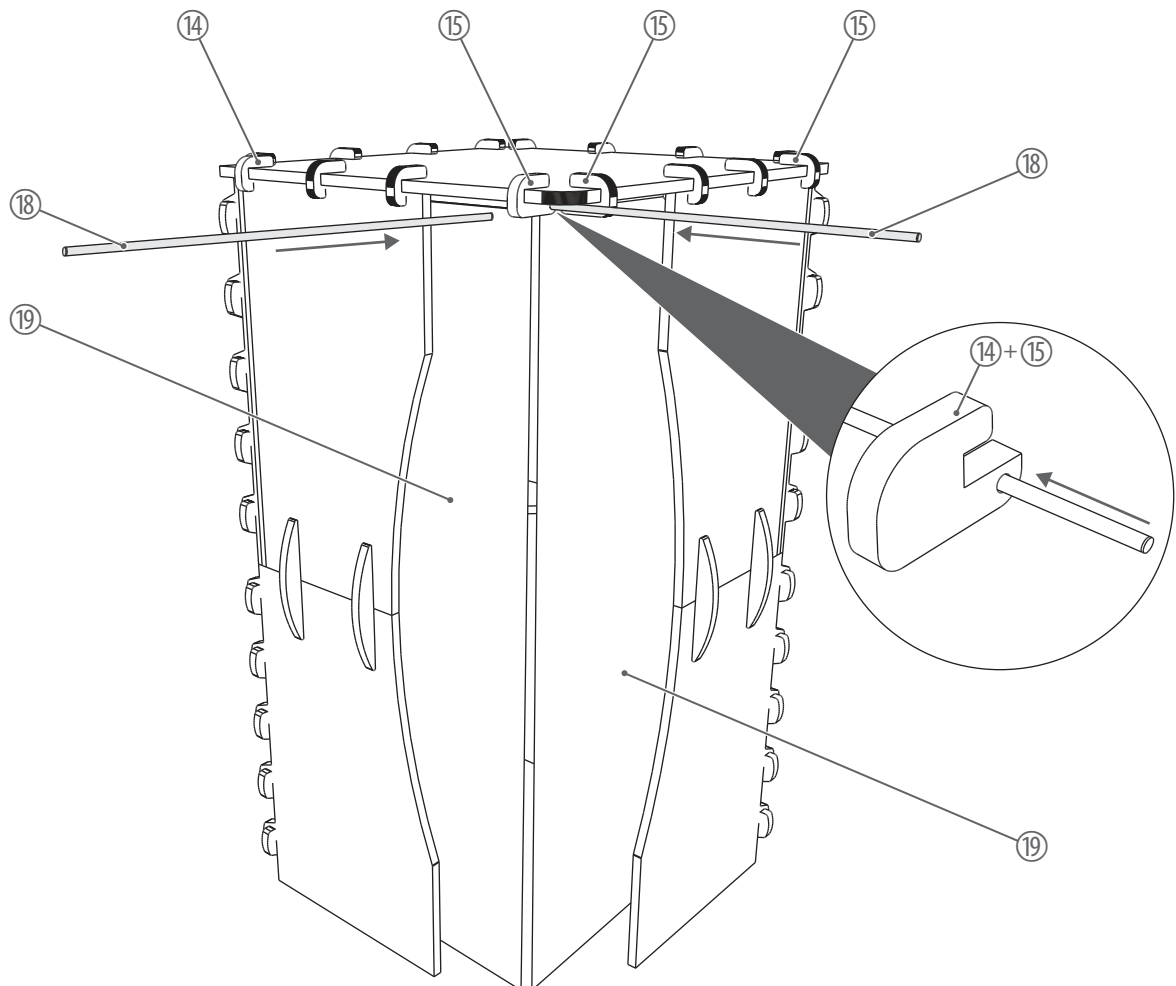

Step 9

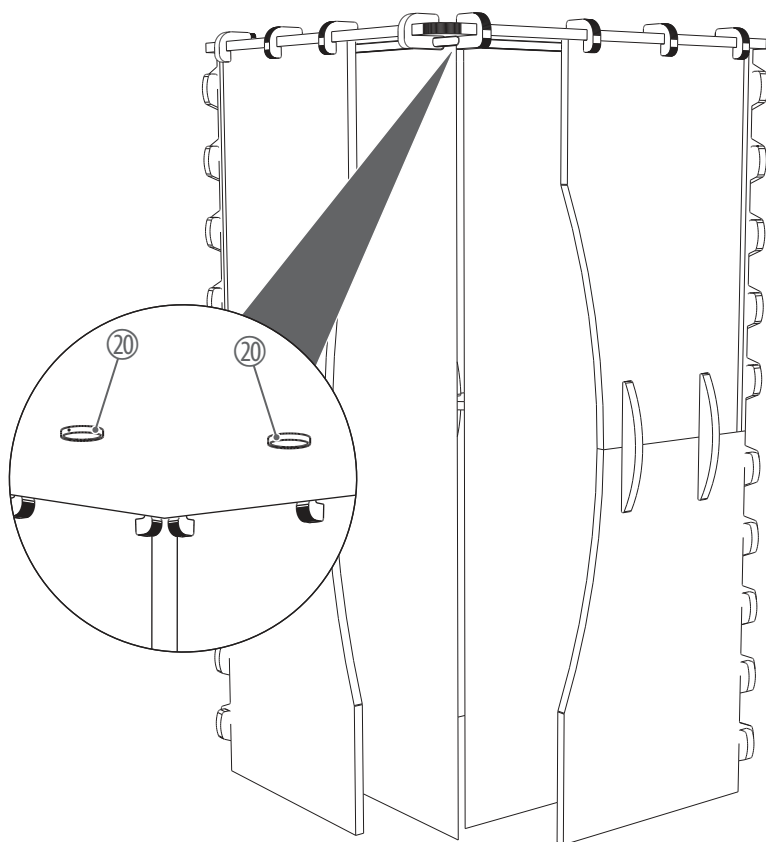

6 Disassembling

Step 1

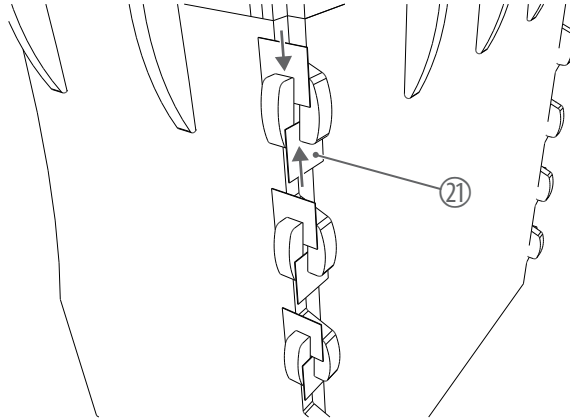

Use the supplied paper sheets (21) to make disassembly easier. Push a paper sheet between each pair of connectors. This allows the PET panels to be pulled apart more easily.

7 Technical specifications

Material		PET, 25 mm, 3000 g/m ² Flame retardant building material class B-s1, d0 as per DIN EN 13501-1
Colour		Silver grey
Absorption		NRC = 0.9
Battery LED lamps		3 × AAA each
Dimensions	Booth (W × H × D)	Outside: 1,100 mm × 2,065 mm × 1,100 mm Inside: 1,000 mm × 2,040 mm × 1,000 mm
	Shelf (W × H × D)	400 mm × 25 mm × 400 mm, height above ground 1,030 mm
	Curtain (W × H)	450 mm × 1,950 mm
Maximum load capacity of shelf		2 kg
Weight		29 kg
Ambient conditions	Temperature range	0 °C - 40 °C
	Relative humidity	20% - 80% (non-condensing)

8 Protecting the environment

Disposal of the packing material

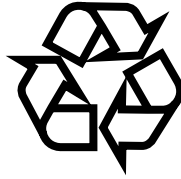

Environmentally friendly materials have been chosen for the packaging. These materials can be sent for normal recycling. Ensure that plastic bags, packaging, etc. are disposed of in the proper manner.

Do not dispose of these materials with your normal household waste, but make sure that they are collected for recycling. Please follow the instructions and markings on the packaging.

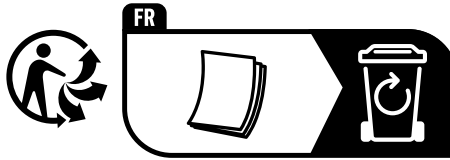

Observe the disposal note regarding documentation in France.

Disposal of batteries



Batteries must not be thrown away or burnt, but must instead be disposed of in line with the local regulations on the disposal of hazardous waste. Use the available collection sites.

Before disposing of your old device, remove the batteries if this is possible without destroying it.

Dispose of the batteries or rechargeable batteries at suitable collection points or through your local waste facility.

Disposal of your old device

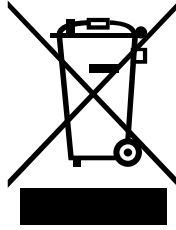

This product is subject to the European Waste Electrical and Electronic Equipment Directive (WEEE) as amended.

Do not dispose of your old device with your normal household waste; instead, deliver it for controlled disposal by an approved waste disposal firm or through your local waste facility. If in doubt, consult your local waste management facility. You can also return the device to a retailer if they offer to take the device back for free or if they are legally obliged to do so. When disposing of the device, comply with the rules and regulations that apply in your country. You can also return your old device to Thomann GmbH at no charge. Check the current conditions on www.thomann.de.

Proper disposal protects the environment as well as the health of your fellow human beings. This is because the proper handling of old devices negates the potential negative effects of hazardous substances, and because it conserves resources by recycling them.

Also note that waste avoidance is a valuable contribution to environmental protection. Repairing a device or passing it on to another user is an ecologically valuable alternative to disposal.

If your old device contains personal data, delete those data before disposing of it.

